



## CT Energy Harvesting Device

TRGK-type CT energy harvesting device for high-voltage transmission lines is a new type of induction energy harvesting device, which uses electromagnetic energy around induction high-voltage transmission lines to harvest electric energy. After rectification, filtering and voltage stabilization, a stable and reliable DC voltage is obtained.



TRGK

### Technical Data

Open-type energy harvesting CT current transformer				
Electrical Parameters	Working Voltage Level of Transmission Line	≤200kV	Power Frequency Withstand Voltage	Primary side and secondary side AC 2.5kV 1min
	Working Range	AC 10 ~ 1000A	Anti-open Circuit Voltage	90V AC
	CT Output Power	≤40W	Frequency Range	50Hz-400Hz
Mechanical Parameters	Output Mode	Terminal or copper core cable	Protection Level	IP66
Energy harvesting power supply module				
Electrical Parameters	Output Voltage Range	+5V ~ +24V DC	Power Range	5W ~ 20W
	Accuracy	±2%	Load Adjustment Rate	±0.5%
	Temperature Drift	±0.03%/°C	Frequency Range	40Hz ~ 60Hz

### Overall Dimensions

Dimension unit: mm

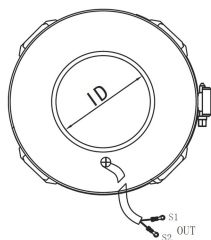

Front View

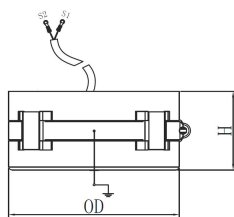

Bottom View

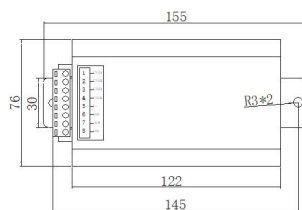

Front View

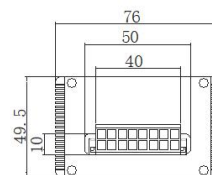

Side View

Inner Diameter(ID)	Outside Diameter(OD)	Height(H)
50	110	53
120	205	85
160	250	80
180	270	80
200	300	55